

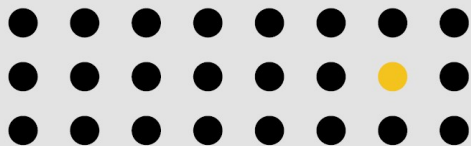

# PROM CERAMICS

**HIGH-QUALITY  
PRODUCTS FOR  
FIRE ASSAYING**



**КОМПАНИЈА ПРОМЦЕРАМИКА  
PROMCERAMICS  
WAS ESTABLISHED IN 2014 AND  
SINCE THEN HAS GAINED  
THE STATUS OF ONE OF THE  
LEADING MANUFACTURERS OF  
CRUCIBLES, CUPELS AND  
SCORIFYING DISHES.**

Our production designs the tools for manufacturing any products used in the laboratory analysis for gold mining, refining and jewellery companies. Our clients have the opportunity to use our high-quality products made on the basis of the technology guidelines developed based on the requirements of the Russian State Standards GOST.

PromCeramics continually performs R&D, experimental studies, as well as relevantly adopts new materials, and suggests the advanced technologies. Our collaboration with the School of Non-Ferrous Metals and Materials Science of Siberian Federal University allows developing advanced solutions for manufacturing.



**6 TYPES OF PRODUCTS AND  
24 ITEMS OF  
PRODUCTION**



**34 HIGHLY-QUALIFIED  
EMPLOYEES WITH LONG  
YEARS OF SERVICE AND  
PRACTICE IN THE  
INDUSTRY**



**50 MILLION ROUBLE  
PRODUCTION INVESTMENT**



**CUSTOMISED TOOL  
MANUFACTURING**

---

**OUR PRODUCTION IS CERTIFIED BY  
ISO 9001, ISO 14001, BS OHSAS 18001**

**THE VARIETY OF OUR PRODUCTS IS CONSTANTLY EXPANDING, AND WE ARE READY TO CONSIDER ANY PROPOSALS ON MANUFACTURING BOTH ACCORDING TO THE STANDARD DIMENSIONS, OR TO DRAWINGS AND SKETCHES OF OUR CUSTOMERS.**

Fire assaying is the main method for defining most of the precious metals, the main stages of which are crucible or scorifying melting, cupelling. The success of the assaying significantly depends on the properties and quality of the assay labware.

PromCeramics uses only certified high-quality materials, and our quality management system meets the requirements of the Russian State Standards of GOST R ISO 9001-2015 (ISO 9001: 2015), which ensures the quality at all levels of the product life cycle.

Our production employs the highly-qualified personnel and is fitted out with state-of-the-art equipment, located in the secured premises, and capable of increasing the production performance and quick re-equipping for the production of various products customised for the needs of our customers. We can design tools for manufacturing of any products used in laboratory analysis at the gold mining, processing and jewellery enterprises.



---

**TODAY, PROMCERAMICS PRODUCTS ARE SUPPLIED TO THE COMPANIES OF THE URALS, SIBERIA, THE FAR EAST, YAKUTIA AND THE REPUBLIC OF KAZAKHSTAN.**

## CRUCIBLES

PromCeramics manufactures fireclay crucibles. Our crucibles allow the performance of more than 20 cycles when working on geological samples, and for a particularly aggressive media (mixtures consisting of PbO and CuO) we use a special charge mixture for crucibles, which, when properly used, can withstand up to 10 cycles. Thanks to their excellent preparation and experience gained, the specialists of PromCeramics are ready to offer an extensive range of options for crucibles, as well as to develop and manufacture customised samples for your needs.

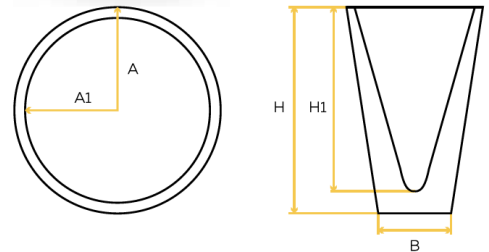

### Product specification

Designation	Capacity, cm <sup>3</sup>	Weight, gr	Dimensions, mm				
			A	A1	H	H1	B
Crucible 0	5	19	26	20	40	35	32
Crucible 1	30	165	54	40	65	50	40
Crucible 2	75	310	68	43	80	65	68
Crucible 3	200	675	92	78	112	90	68
Crucible 3a (40G)	340	470	84	75	140	124	50
Crucible 4	450	900	110	94	135	115	68
Crucible 4a (50G)	500	600	105	97	140	125	55
Crucible 5	500	1250	110	90	155	135	68
Crucible 5a (65G)	600	860	105	92	165	140	55
Crucible 6	600	1330	130	110	155	135	68
Crucible 7	750	1800	125	105	210	195	60



## CUPELS

PromCeramics commercially manufactures magnesite blocks and cupels, according to the Russian State Standard GOST, and their quality is consistent and confirmed by the certificates. A wide range of cupel sizes provides a solution to any analytical tasks for determining precious metals. The lead oxide absorption capacity is 75% of the mass of a cupel. The use of our cupels allows ensuring pin-point accuracy of the analysis, even on lean ores.



**GOST**

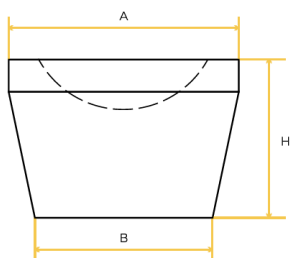

### Product specification

Designation	Capacity, cm <sup>3</sup>	Weight, gr	Dimensions, mm		
			A	H	B
Cupel 1	6	11	22	22	18
Cupel 2	20	30	30	28	25
Cupel 7a	40	60	39	30	30
Cupel 7x	60	80	40	37	30
Cupel 8	55	73	44	31	36
Cupel 8a	75	95	44	37	36
Cupel 8s	85	107	44	41	36
Block 4HB	75	100	48x48	20	48x48
Block 12HB	281	375	165x60	20	165x60
Block 14HB	275	367	179x54	20	179x54

## SCORIFYING DISHES

PromCeramics produces scorifying dishes. Our scorifying dishes are made of qualitative raw materials with  $Al_2O_3$  content of more than 40%. Our product is highly corrosion-resistant, has a clean surface after melting and withstands up to 10 fusions. We offer a wide range of choice and are also ready to make customised scorifying dishes according to your drawings.



GOST

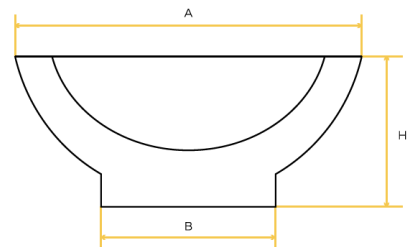

### Product specification

Designation	Weight, gr	Dimensions, mm		
		A	H	B
Scorifying dish 1	100	63	27	38
Scorifying dish 2	110	65	32	40
Scorifying dish 3	140	80	35	58

**IN ADDITION TO THE STANDARD SIZES, WE ALSO MANUFACTURE PRODUCTS TO OUR CUSTOMER SKETCHES**

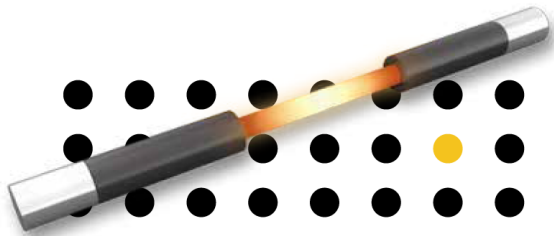

## ELECTRIC HEATERS

PromCeramics produces silicon carbide electric heaters. Our heaters have low porosity and high density. Their service life is at least 10,000 hours, if adhering to the operating conditions. At the moment we are ready to manufacture and supply heaters of the following types: SEH A SG, SEH B, SEH V SG, or customise the heaters according to the drawings of the customer.

Silicon carbide heaters (SEH) are widely used in the high-temperature electric resistance-type furnaces. Compared to the heaters of resistance alloys (nichrome and kanthal), they have several advantages: high-temperature application (temperature in the furnace chamber up to 1400 °C in air and neutral atmosphere, and up to 1200 °C in reducing atmosphere), high specific electrical resistance, easy to replace failed heating elements without a prolonged banking of the furnace.



**GOST**

### Product specification

Designation	SEH A SG	SEH B	SEH V SG
Mass fraction of SiC, not less than, %	97	97	97
Voltage, V	151-44	162-31	162-31
Current, A	151-22	203-18	203-22
Resistance, Ω	0,5-7,2	0,28-5,7	0,25-3,5



## CERAMIC TRAYS

PromCeramics produces ceramic trays. Our trays are made of high-quality materials and are a natural choice when using on gold- and silver-bearing ore alloys. We are ready to manufacture customised ceramic trays according to your drawings.



GOST



**MAKE TO ORDER**

## MUFFLES

PromCeramics manufactures muffles for furnaces. Our muffles provide even thermal heating of chambers, have high thermal conductivity and enable to obtain the temperature of more than 1100 °C. We are readily able to make any ceramic muffles specially for your production.



GOST



**MAKE TO ORDER**

---

**PROMCERAMICS ALSO PROVIDE FIRE PROTECTION SERVICES. OUR SPECIALISTS PROVIDE LINING: VERTICAL AND HORIZONTAL GAS GAS FLUES (CHIMNEYS), FUEL TILTING FURNACES, ORE-THERMAL FURNACES (CIRCULAR, CLOSED-TOP), DC ARC FURNACES, TILTING-TYPE ELECTRIC-ARC FURNACE, LABORATORY FURNACES. THE APPLICABLE FIRE-RESISTANT MATERIALS: BRICK - CHROME-PERICLASE, FUSED MAGNESIA, CHAMOTTE BRICKS OF A AND B REFRACTORINESS GRADES, AND LIGHT-WEIGHT CHAMOTTE BRICKS, ASBESTOS CARDBOARD, FIBERFRAX AND DURABLANCKET FIRE-RESISTANT BLANKETS.**



## LABORATORY TOOLS

PromCeramics company specializes in manufacturing laboratory tools by reference to sketches of our customers and also is ready to provide a progressive multi-casting method for 25 or 50 crucibles, which reduces the labour costs and increases its safety.

PromCeramics produces tools ensuring operational comfort during the cupelling test. We have standard samples that you can order, or we will design any specific tool to suit your needs.

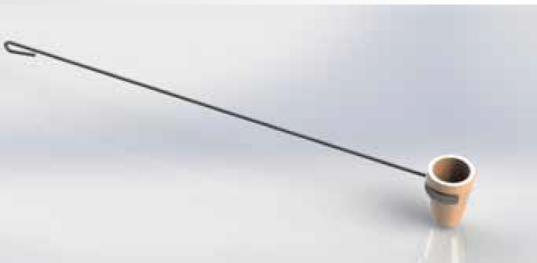

## OUR PARTNERS





## CONTACTS

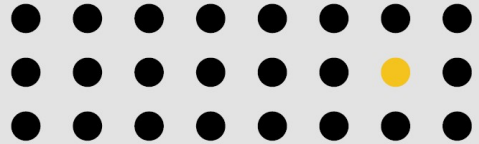

**Address: bldg. 16, 73a  
Energetikov Street,  
Krasnoyarsk, 660130  
Phone: +7 (391) 2181836  
E-mail: [mail@promceramica.com](mailto:mail@promceramica.com)  
[promceramica.com](http://promceramica.com)**

